

製造科技研究所
Institute of Manufacture
Technology

機械設計與模擬分析
Mechanical Design and
Simulation Analysis

資通訊科技應用實驗室
(ICT Lab)



O: 綜科 711-2
#2069

L: 綜科 711-2
#2069

陸元平副教授
Associate Prof. Yuan-Ping Luh

康乃爾大學
Cornell University
yuan@mail.ntut.edu.tw
<http://ar.ntut.edu.tw/lab/index.aspx?lab=1178>

■ 研究領域

協同產品設計與開發、RFID產業應用、金屬鍛造模擬分析、故障預測與健康管理系統、電腦視覺技術之應用、模具之異型水路設計之研究

■ 近期研究主題

- 模具產業導入供應鏈管理之研究
- 設計拓譜最佳化之球鞋中底探討
- 主動式腰部支撐型背墊機構設計與分析
- 半導體製程真空幫浦故障預測
- 冷間鍛造硬度預測分析
- 射出成形模具熱補償異型水路設計之研究

■ Research Area

Collaborative Product Design、RFID industrialization of scientific、Simulation Analysis of Metal Forging、Prognostic and Health Management of System、Computer Vision Techniques Application、Research on Design of Cooling Channel in Molding

■ Recent Topics

- A Study on Supply Chain Management in Mold Industry
- Photoacoustic medical imaging
- Application of Topology Optimization in Shoe Midsole Design
- Mechanical Design and Analysis of Back Pad with Active Lumbar Support
- Vacuum Pump Fault Prediction in Semiconductor Processing
- Research on Design of Conformal Cooling Channel in Injection Molding on Thermal Compensation

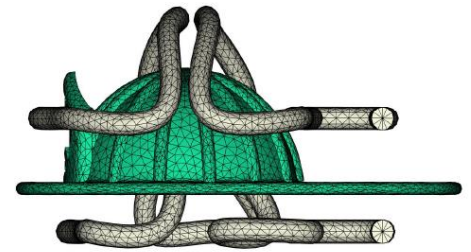

固定側使用熱點方法可動側使用補償方法建置的異型水路圖

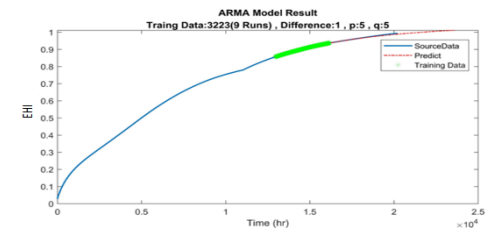

演算建立真空幫浦故障預測模型

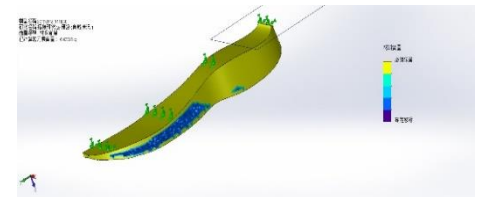

拓撲最佳化後的鞋中底模型

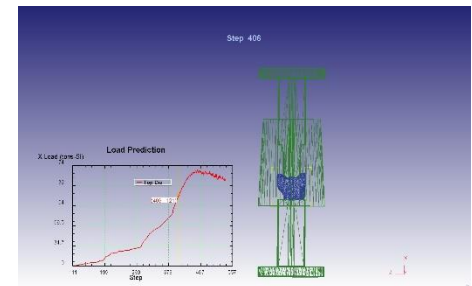

沖壓模具噸重分析